



16 Martlesham Walk, London

Offers Over £275,000

JOSEPH SCOTT



16 Martlesham Walk

London, London

Joseph Scott Presents

A beautifully presented and thoughtfully upgraded one bedroom apartment offering generous living space, contemporary finishes and excellent natural light throughout, as well as double glazing throughout. Only 0.6 miles to Colindale station (Northern Line).

The heart of the home is the impressive open plan living, kitchen and dining space. This room has been carefully designed to feel both stylish and practical, with a modern fitted kitchen featuring integrated appliances, extensive worktop space and a breakfast bar that comfortably seats several people. The living area easily accommodates full size furniture and benefits from large windows that bring in plenty of natural light and provide a pleasant outlook.

The double bedroom is well proportioned and finished in a calm, modern style. It benefits from a fitted wardrobe providing excellent built in storage while still allowing space for additional bedroom furniture. Large windows ensure the room remains bright and airy throughout the day.

The family bathroom is finished in a clean contemporary style with a full sized bath and overhead shower, modern tiling and quality fittings. The overall presentation is neutral and well maintained, making the space both practical and visually appealing.

The entrance hallway is a real strength of the property, offering excellent storage options.



First Floor Flat

Approx. 48.9 sq. metres (526.7 sq. feet)

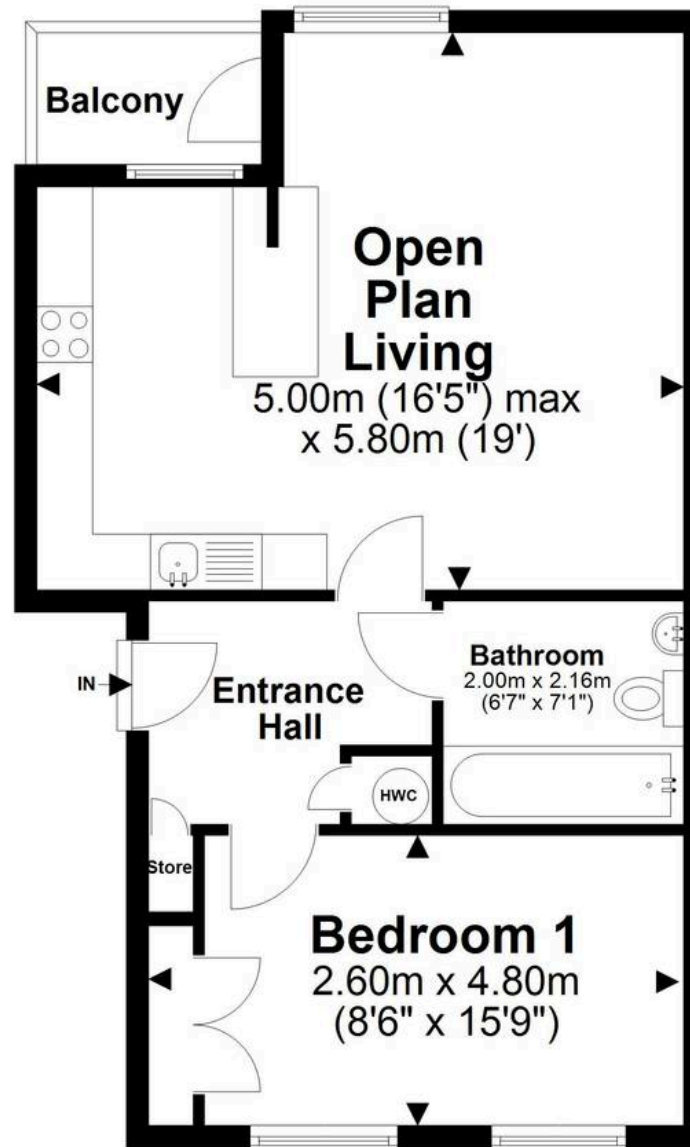

Total area: approx. 48.9 sq. metres (526.7 sq. feet)

All images used are for illustrative purposes only. Floor plan are intended to give a general indication of proposed layout only. All images and dimensions do not form of any contract or warranty.

Plan produced using PlanUp.

Martlesham Walk, London, NW9 5BF