



Flat 80, Conrad Court, 2 Needleman Close

Offers Over £385,000

JOSEPH SCOTT



Flat 80

Conrad Court, London

Joseph Scott Presents:

Chain Free: Modern 2-Bed, 2-Bath Apartment in Pulse Development, Colindale

Situated on the first floor of a modern purpose-built block with lift access, this spacious apartment offers comfortable, contemporary living with exceptional local convenience in the vibrant Pulse development.

The property comprises two double bedrooms and two tiled bathrooms, both featuring heated towel rails. The spacious open-plan living and kitchen area is flooded with natural light, thanks to floor-to-ceiling windows and a dual-aspect layout in the living room. The kitchen is fully fitted with modern appliances, ideal for both everyday living and entertaining.

The apartment also features central heating, double-glazed floor-to-ceiling windows, and a bright, airy feel throughout. Montrose Park, a local Sainsbury's, and other everyday amenities are just moments away.

Set in a popular residential neighbourhood, this apartment is just 0.2 miles from Colindale Tube Station (Northern Line), which is currently undergoing a major refurbishment—offering excellent connectivity and long-term value.

Lease: Approx 111 years remaining

Ground rent: £250 per annum



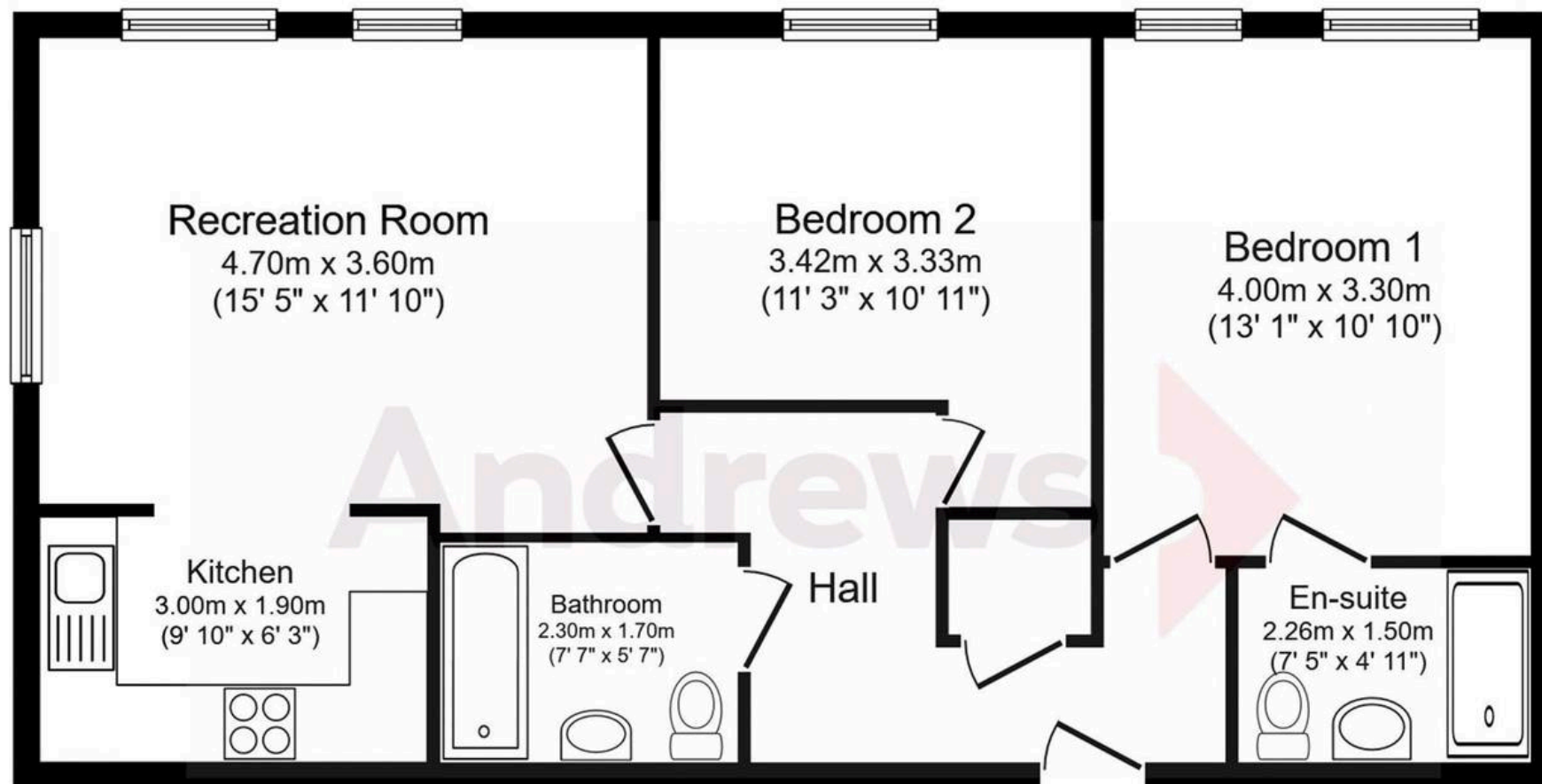

Floor Plan

Conrad Court, 2 Needleman Close, London, NW9
Total floor area 65.0 sq. m. (700 sq. ft.) approx

This plan is for illustration purposes only and may not be representative of the property. Plan not to scale.

Powered by Audioagent.com