



22 Bradman Row Pavilion Way, Edgware

Offers Over £170,000

**JOSEPH SCOTT**





## 22 Bradman Row Pavilion Way

Edgware, Edgware

Joseph Scott presents:

CHAIN FREE!

A Well Presented Top Floor Studio Flat, With  
Allocated Parking, Located Only 0.8 Miles From  
Burnt Oak Station!

Walking into this property, you are greeted with a  
spacious living area, complete with direct  
access into the separate kitchen.

Further to the living area, there is a stylish family  
bathroom, as well as the added perk of ample  
storage space.

Benefits include it's close proximity to key  
transport links, local amenities and schools.

Lease length: Circa 86 years

Service Charge: Circa £1,014.28 per year

Council Tax Band: C

Council Tax band: TBD

Tenure: Freehold

EPC Energy Efficiency Rating: D







Approx. 26.6 sq. metres (286.3 sq. feet)

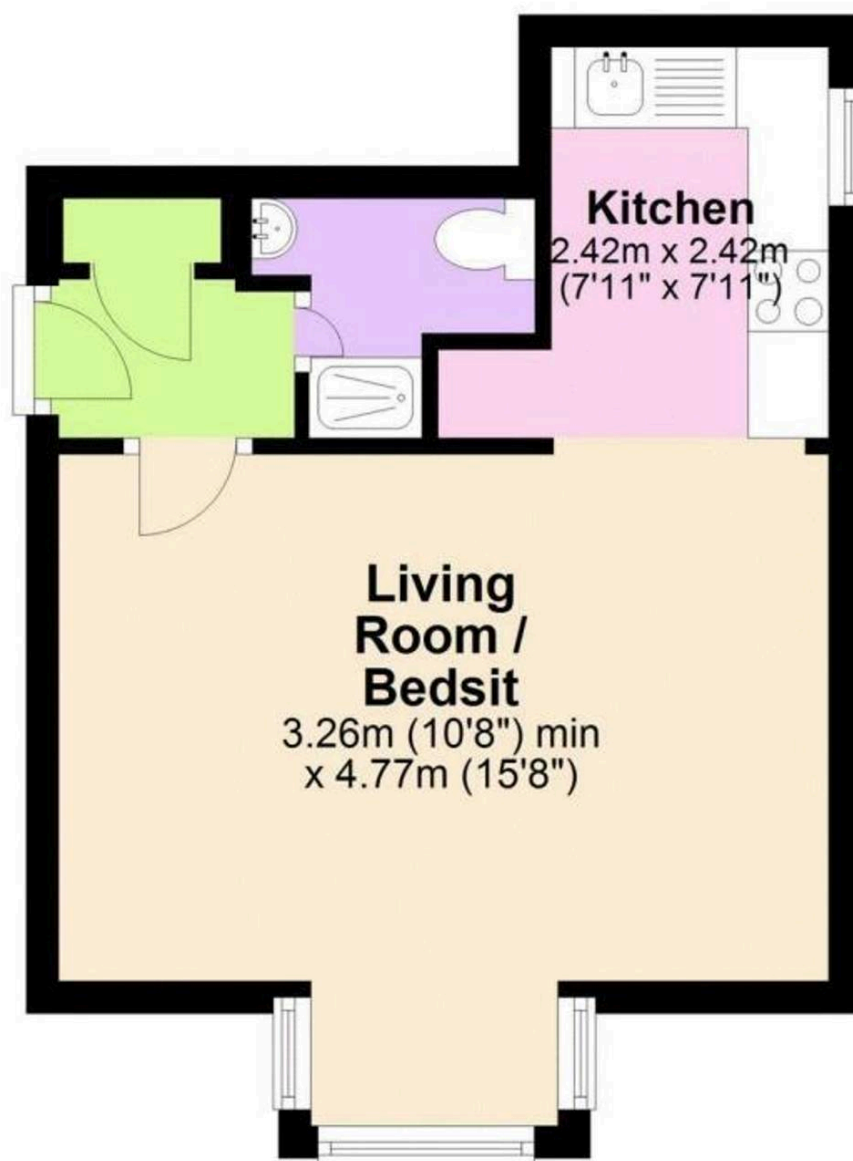

Total area: approx. 26.6 sq. metres (286.3 sq. feet)

The measurements given are approximate and are for illustration only . They should not be relied on for valuation .

Plan produced using PlanUp.