



17 Bloomsbury Close, London

Offers Over £300,000

JOSEPH SCOTT



17 Bloomsbury Close

London, London

Joseph Scott presents:

This bright and well-maintained one-bedroom apartment is situated on the first floor of a modern purpose-built development. It offers an open-plan living area with a fitted kitchen and integrated appliances, a bathroom, a separate W/C, and double-glazed windows throughout. The property also benefits from a large storage cupboard, providing valuable extra space.

Off-street allocated parking is included and only 0.6 miles from Mill Hill Broadway Station (Thameslink).

Lease Length: Circa 101 years remaining

Service Charge: Circa £1637.32 per year

Ground Rent: Circa £175 per year

Council Tax Band: D Barnet

Council Tax band: TBD



FIRST FLOOR
476 sq.ft. (44.2 sq.m.) approx.

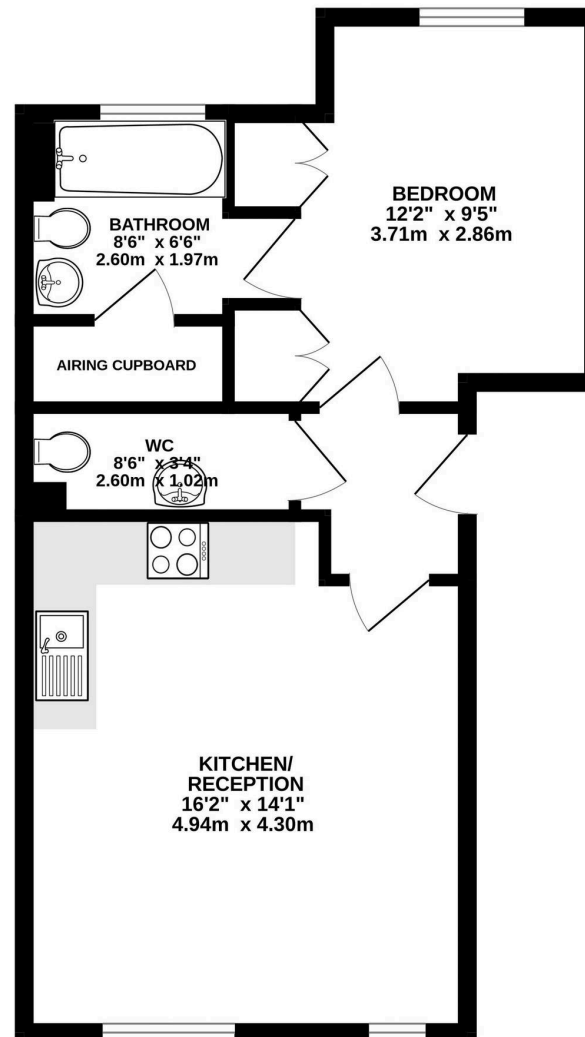

BLOOMSBURY CLOSE, LONDON, NW7 2DT

TOTAL FLOOR AREA : 476 sq.ft. (44.2 sq.m.) approx.

Whilst every attempt has been made to ensure the accuracy of the floorplan contained here, measurements of doors, windows, rooms and any other items are approximate and no responsibility is taken for any error, omission or mis-statement. This plan is for illustrative purposes only and should be used as such by any prospective purchaser. The services, systems and appliances shown have not been tested and no guarantee as to their operability or efficiency can be given.
Made with Metropix ©2025